

REMOVAL

1. DISCONNECT CABLE FROM NEGATIVE BATTERY TERMINAL
2. REMOVE PARKING BRAKE HOLE COVER SUB-ASSEMBLY (See page [IP-11](#))
3. REMOVE SHIFT LEVER KNOB SUB-ASSEMBLY (for Manual Transmission) (See page [IP-11](#))
4. REMOVE SHIFT LEVER KNOB SUB-ASSEMBLY (for 4WD) (See page [IP-11](#))
5. REMOVE CONSOLE UPPER REAR PANEL SUB-ASSEMBLY (See page [IP-12](#))
6. REMOVE PARKING BRAKE SWITCH
 - (a) Disconnect the parking brake switch connector.
 - (b) Remove the screw and parking brake switch.

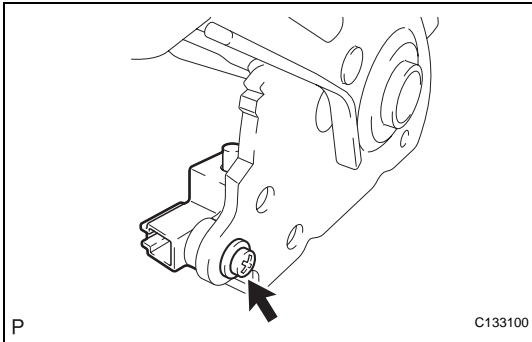

INSPECTION

1. INSPECT PARKING BRAKE SWITCH

- (a) Check the resistance.
 - (1) Using an ohmmeter, measure the resistance between the terminals.

Standard resistance

Tester Connection	Switch Condition	Specified Condition
1 - Ground	Released	Below 1 Ω
1 - Ground	Pushed in	10 k Ω or higher

If the result is not as specified, replace the parking brake switch.

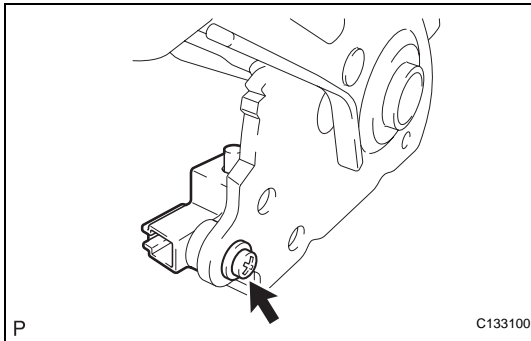

INSTALLATION

1. INSTALL PARKING BRAKE SWITCH

- (a) Install the parking brake switch with the screw.
- (b) Connect the parking brake switch connector.

2. INSTALL CONSOLE UPPER REAR PANEL SUB-ASSEMBLY (See page [IP-31](#))

3. INSTALL SHIFT LEVER KNOB SUB-ASSEMBLY (for 4WD) (See page [IP-32](#))

4. INSTALL SHIFT LEVER KNOB SUB-ASSEMBLY (for Manual Transmission) (See page [IP-32](#))

5. INSTALL PARKING BRAKE HOLE COVER SUB-ASSEMBLY (See page [IP-32](#))

6. CONNECT CABLE TO NEGATIVE BATTERY TERMINAL

Torque: 3.9 N*m (40 kgf*cm, 35 in.*lbf)